

**The Extended Degree
Programme in Engineering
at
London South Bank University**

July 2013

Steve Faulkner, Course Director & Senior Lecturer

T 020 7815 7134 M 07734 816 209 E steve.faulkner@lsbu.ac.uk
Dept. of Applied Sciences,
Faculty of Engineering Science & the Built Environment,
London South Bank University, 103 Borough Road, London SE1 0AA

Purpose of the course

This programme (H101) is aimed at mature learners who have a good general education and some experience of the workplace.

It provides a route into the engineering professions for those who have not followed the traditional route (second chancers) or may have chosen the wrong career path in the first instance. There are also some younger applicants with weak L3 qualifications.

On successful completion of this preparatory year, students progress their studies onto a chosen branch of engineering with a suitable LSBU course. This year is seen as part of the degree programme.

Restructure and Entry requirements

In September 2011 a new 6x20 credit curriculum structure was implemented following validation after the Curriculum Modernisation Project.

Entry requirements

- 40 UCAS points (1 E at A-level)
- BTEC National Diploma
- Other level 3 courses e.g. Access courses
- Plus five GCSEs including Maths and English
- English language qualifications for international students: IELTS score of 6.0, TOFEL - 550 (print-based), TOFEL- 80 (internet-based), Cambridge Proficiency or Advanced Grade C.

Course Breakdown

Semester 1		
Applied Mathematics Credits: 20	Scientific Principles for Engineering Credits: 20	Study & Laboratory Skills Credits: 20
Semester 2		
Mathematics for Engineering Credits: 20	Engineering Science Credits: 20	Stream-specific Module Credits: 20

Stream	Stream specific module Credits: 20
Electronic & Telecom (1FS00)	Practical Electronics
Mechanical & Building Services (1FS01)	Engineering Design & Modelling
Chem & Pet Eng (1FS02)	Chemistry & Applications
Civil (1FS03)	Constructing the Built Environment

FT Extended Degree Programme in Engineering analysis

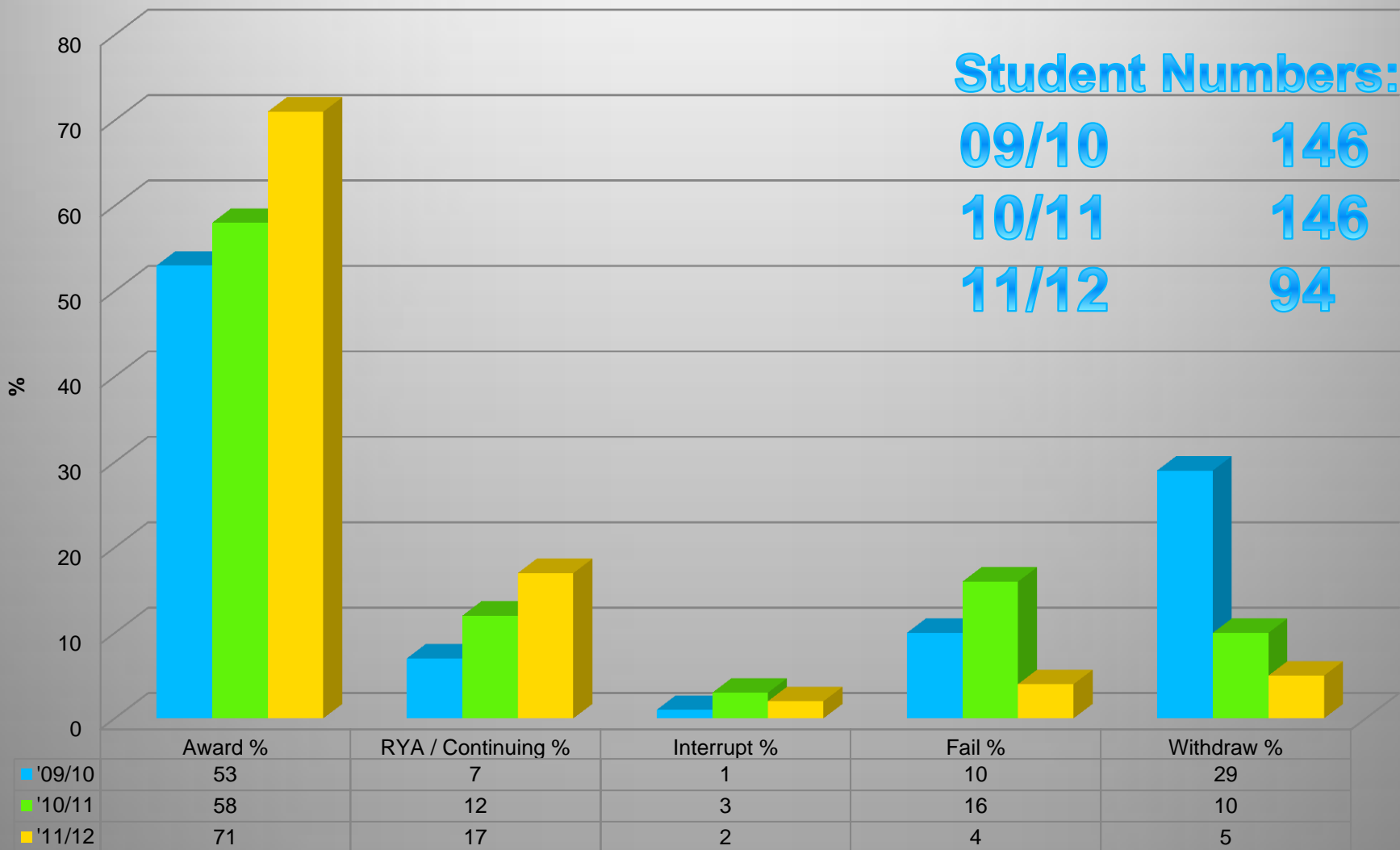

PT Extended Degree Programme in Engineering analysis

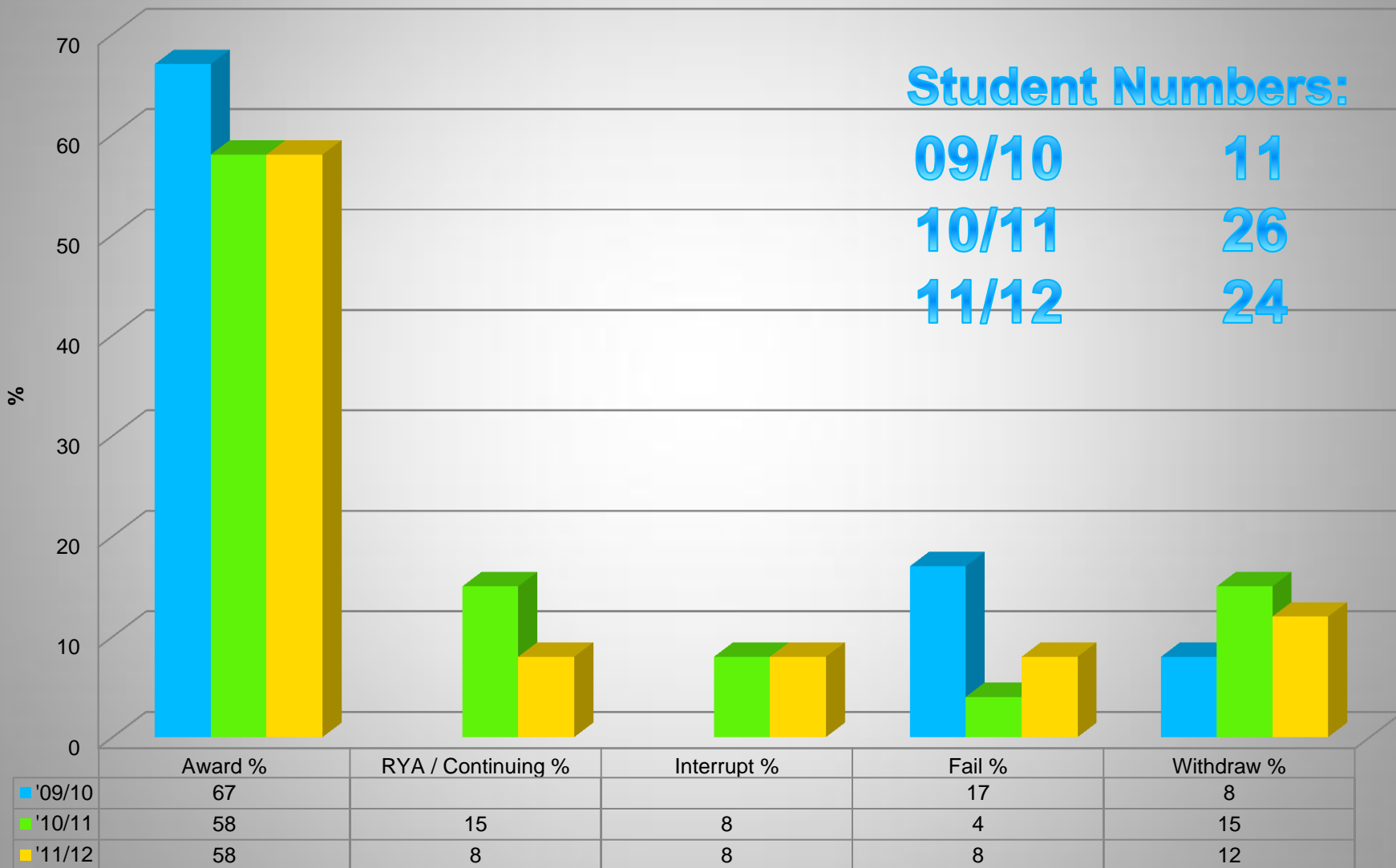

Progression Routes

Electronic and Telecommunication courses (from 1FS00)
BTEC HNC/D Electrical & Electronic Engineering
BEng (Hons) Electrical & Electronic Engineering
BEng (Hons) Telecommunications & Computer Networks Engineering
BEng (Hons) Computer Systems & Networks
Mechanical and Building Services courses (from 1FS01)
BTEC HND Computer-aided Engineering
BTEC HND Building Services Engineering
BSc (Hons) Computer-aided Design
BSc (Hons) Computer-aided Engineering
BSc (Hons) Engineering Product Design
BSc (Hons) Product Design
BSc (Hons) Mechanical Engineering Design
BEng (Hons) Building Services Engineering
BEng (Hons) Mechanical Engineering
BEng (Hons) Mechatronics

Progression Routes

Chemical and Petroleum courses (1FS02)
BTEC HND Chemical Engineering
BEng (Hons) Chemical & Process Engineering
BEng (Hons) Petroleum Engineering
BSc Forensic Science
BSc Sport & Exercise Science
Civil courses (1FS03)
BTEC HNC Civil Engineering
BTEC HNC Railway Engineering
BEng (Hons) Civil Engineering
BSc (Hons) Architectural Engineering
BSc (Hons) Civil Engineering

London South Bank
University

Thank You

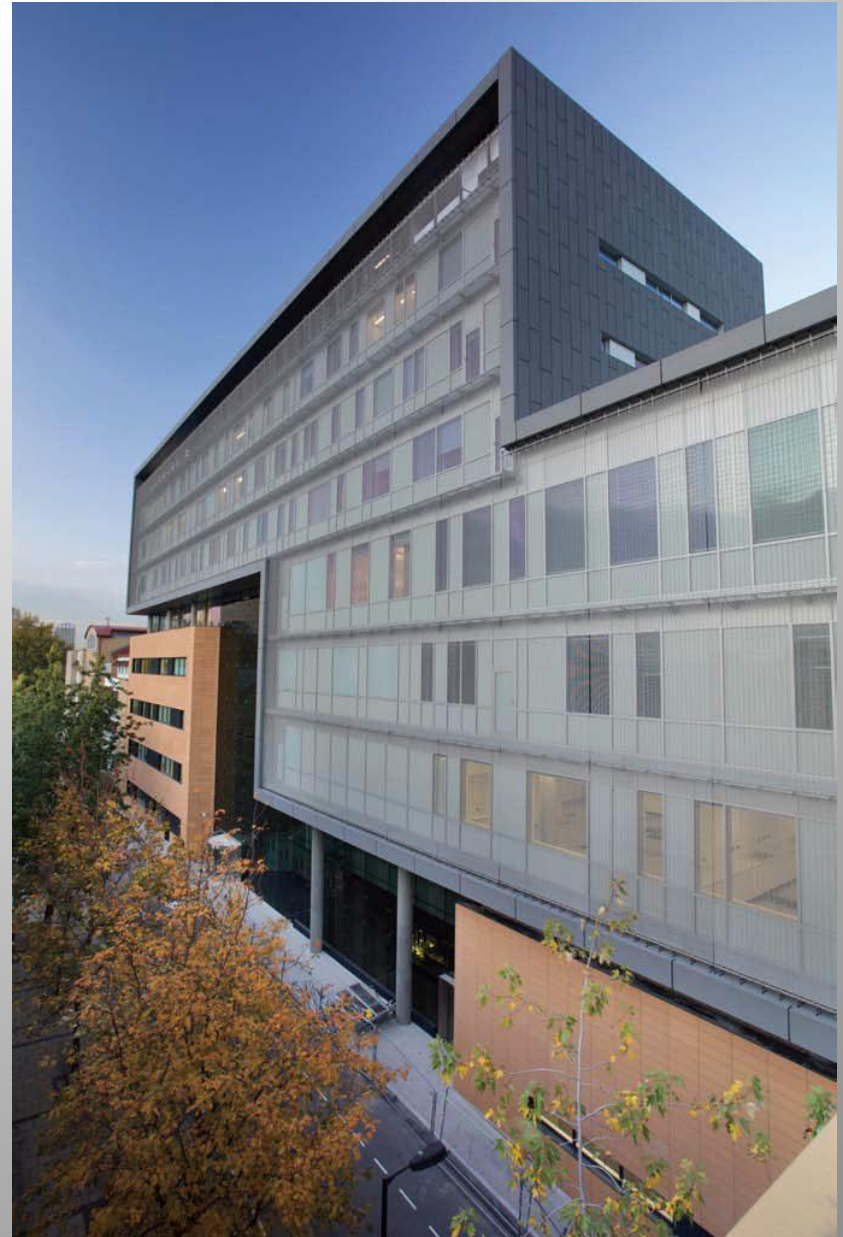

the **brighter** choice